

**aluminorte** Desde 1986  
alumínio e acessórios

Soluções para  
alumínio desde  
1986

**SP | GRID**®  
FACHADA

Sistema  
**Aluminorte**  
Catálogo completo

VERSÃO VII – Outubro 2024

# SP | GRID

## FACHADA

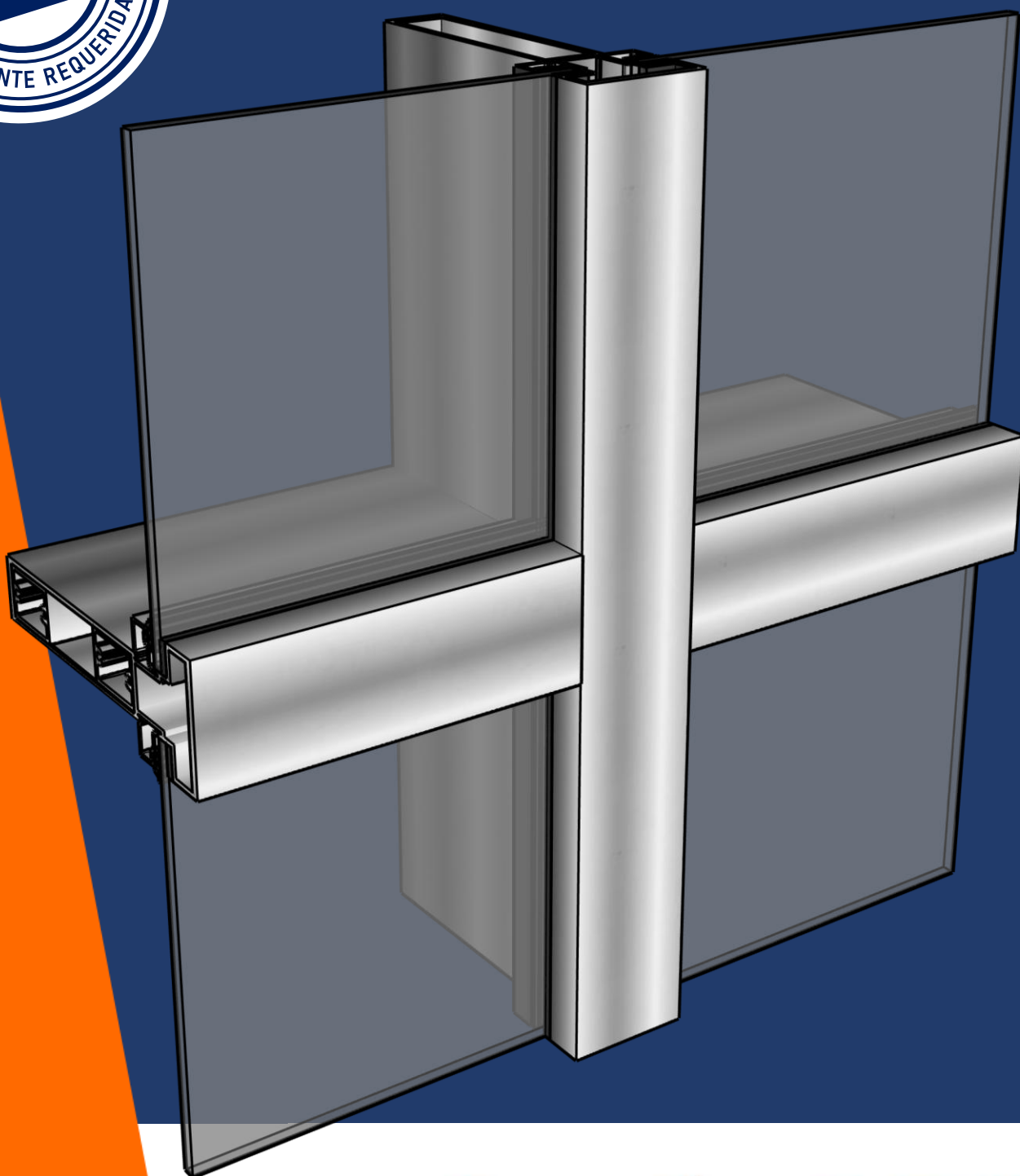

**INPI** INSTITUTO  
NACIONAL DA  
PROPRIEDADE  
INDUSTRIAL

Desde 1986  
**aluminorte**  
alumínio e acessórios

Edifício Valente  
Rua Capote Valente, Pinheiros – São Paulo

Arquitetura FGMF  
Idea Zarvos  
Esquadrias ABA

## Sistema Aluminorte

Sistemas utilizados:



ÍNDICE DE PERFIS	01
PERFIS	02
COMPONENTES	08
PROJETOS ORIENTATIVOS	13





	CÓDIGO	DESCRIÇÃO	PESO	PÁG	
	<b>BG-057</b>	Baguete	0,167 kg/m	<b>08</b>	
	<b>LG-015</b>	Baguete	0,147 kg/m	<b>08</b>	
	<b>LG-026</b>	Baguete	0,158 kg/m	<b>08</b>	
	<b>LG-027</b>	Baguete	0,149 kg/m	<b>08</b>	
	<b>LG-085</b>	Folha	0,529 kg/m	<b>07</b>	
	<b>SPG-003</b>	Marco Glazing	0,543 kg/m	<b>06</b>	
	<b>SPG-004</b>	Folha Glazing	0,250 kg/m	<b>07</b>	
	<b>SPG-005</b>	Coluna e Travessa	2,912 kg/m	<b>03</b>	
	<b>SPG-006</b>	Coluna e Travessa	2,221 kg/m	<b>04</b>	
	<b>SPG-007</b>	Marco	0,455 kg/m	<b>06</b>	
	<b>SPG-008</b>	Tubo Fixador	0,228 kg/m	<b>07</b>	
	<b>SPG-009</b>	Coluna e Travessa	4,365 kg/m	<b>02</b>	
	<b>SPG-010</b>	Complemento da coluna de canto	1,579 kg/m	<b>05</b>	
	<b>SPG – 6199</b>	Coluna e Travessa	3.049 Kg/m	<b>09</b>	
	<b>SPG – 6200</b>	Coluna e Travessa	2,143 kg/m	<b>10</b>	
	<b>SPG – 6201</b>	Coluna e Travessa	1,088 kg/m	<b>11</b>	
	<b>SPG – 6204</b>	Contra tampa	0,688 kg/m	<b>12</b>	
	<b>SPG – 6205</b>	Tampa 21 mm	0,735 kg/m	<b>12</b>	
	<b>SPG – 6206</b>	Tampa 15 mm	0,530 kg/m	<b>12</b>	
	<b>SPG – 6202</b>	Coluna e travessa	1,503 kg/m	<b>13</b>	
	<b>SPG – 6203</b>	Tampa SPG-6202	0,477 kg/m	<b>14</b>	

**SPG-009**

Coluna e Travessa  
4,626 Kg/m

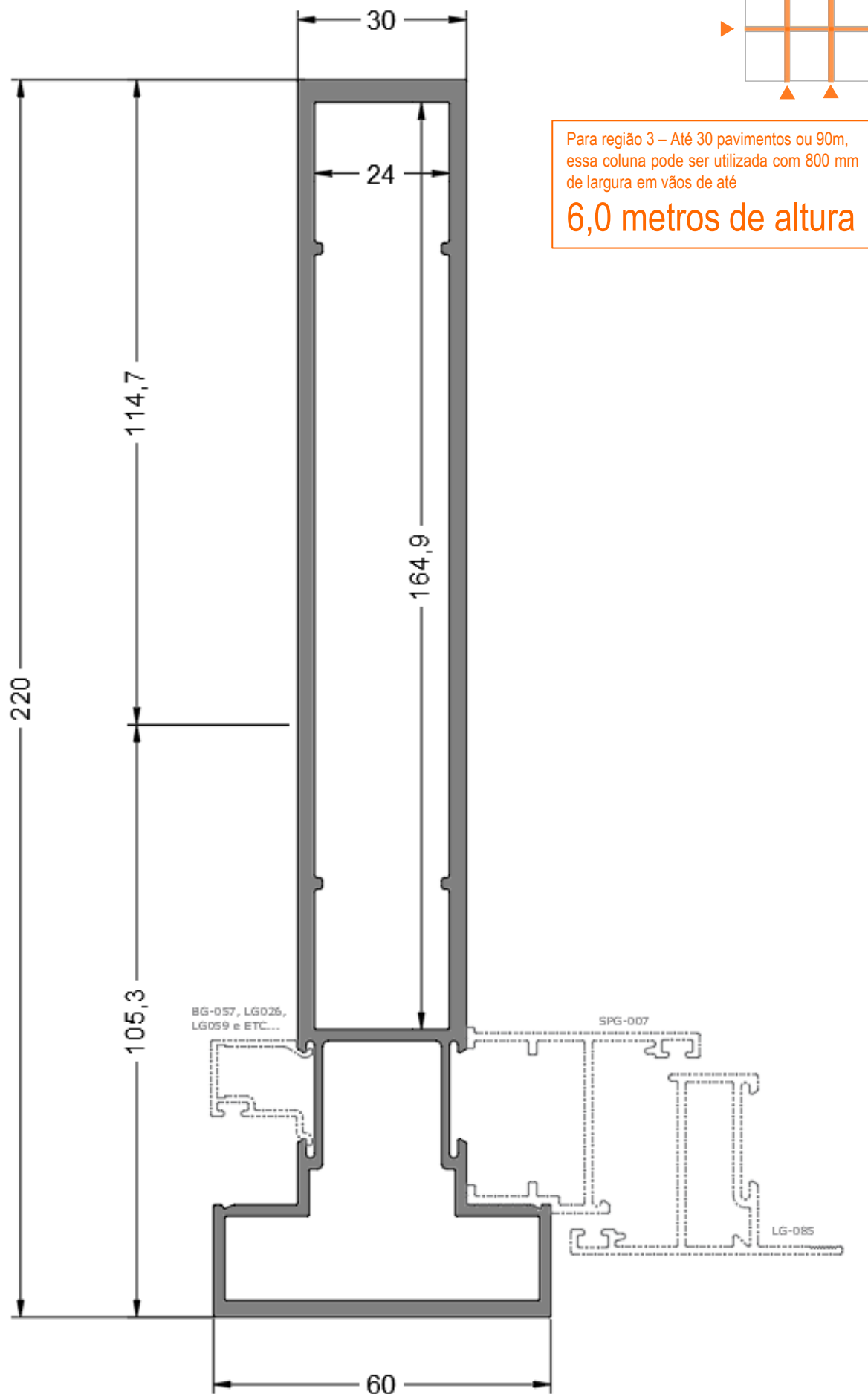

Para região 3 – Até 30 pavimentos ou 90m,  
essa coluna pode ser utilizada com 800 mm  
de largura em vãos de até

**6,0 metros de altura**

Jx= 836.8494 cm<sup>4</sup>

Wx= 72.959 cm<sup>3</sup>

Jy= 35.0642 cm<sup>4</sup>

Wy= 23.376 cm<sup>3</sup>

**SPG-005**

Coluna e Travessa

2,912 Kg/m

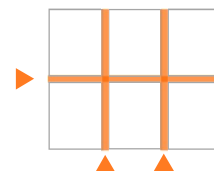

Para região 3 – Até 30 pavimentos ou 90m,  
essa coluna pode ser utilizada com 800mm  
de largura em vãos de até

**4,5 metros de altura**

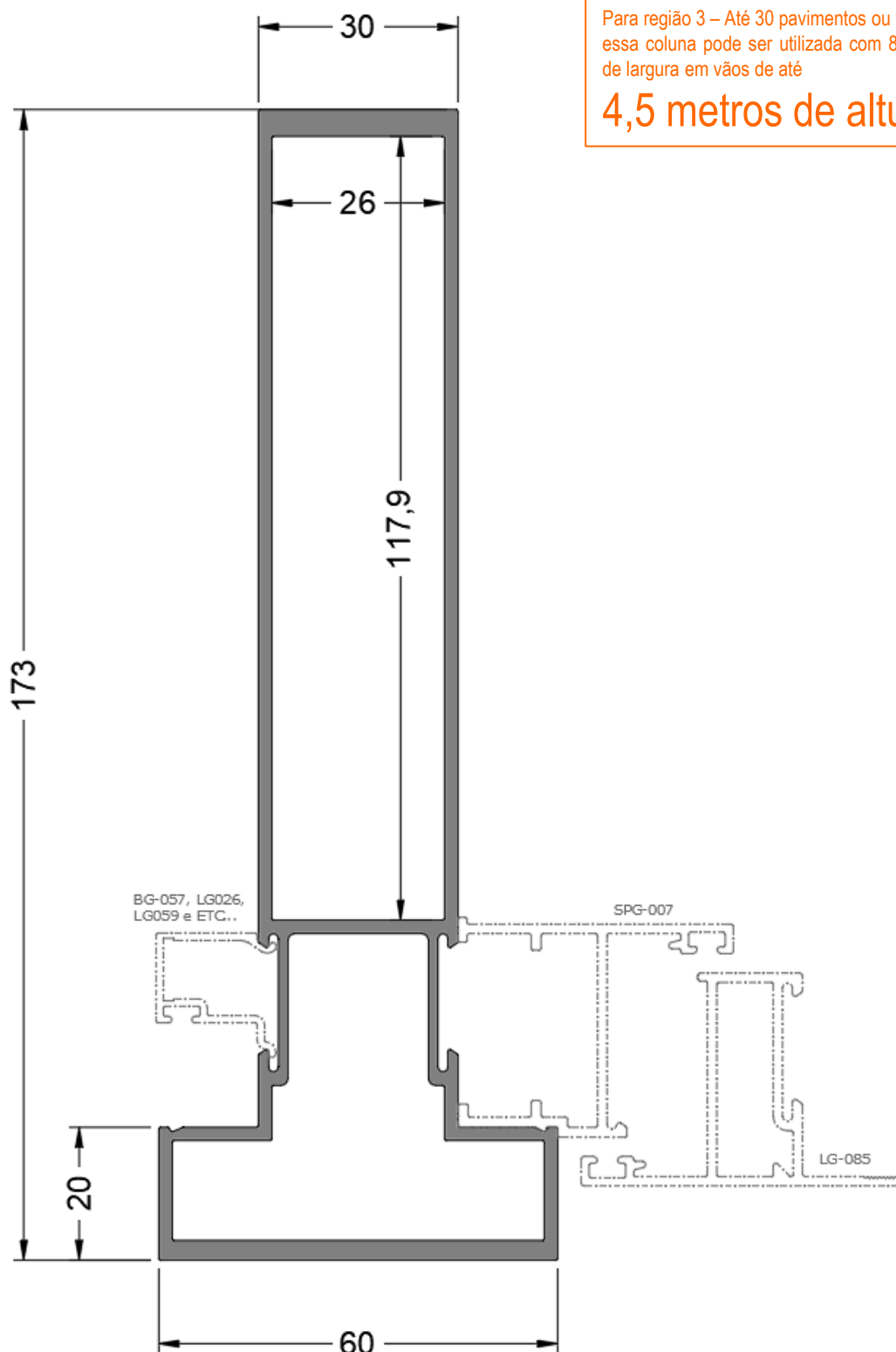

$Jx = 390.972 \text{ cm}^4$	$Wx = 40.223 \text{ cm}^3$
$Jy = 26.073 \text{ cm}^4$	$Wy = 8.691 \text{ cm}^3$

**SPG-006**

Coluna e Travessa

2,221 Kg/m

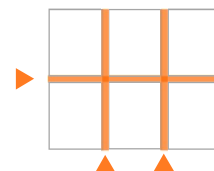

Para região 3 – Até 30 pavimentos ou 90m,  
essa coluna pode ser utilizada com 800 mm  
de largura em vãos de até

**3,5 metros de altura**

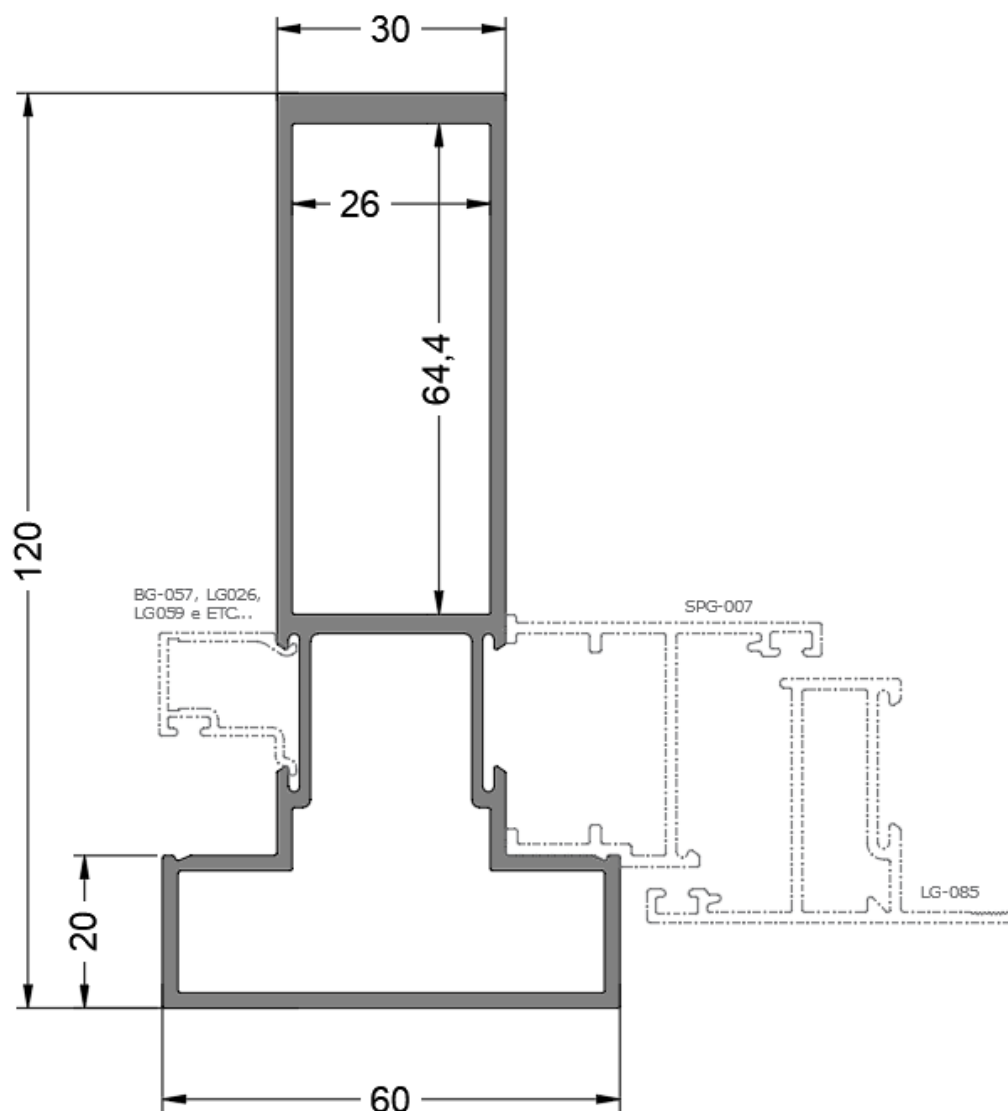

Jx= 141,0403 cm <sup>4</sup>	Wx= 21,833 cm <sup>3</sup>
Jy= 20,521cm <sup>4</sup>	Wy= 6,840 cm <sup>3</sup>



**SPG-010**

Complemento coluna de canto  
1,579 Kg/m

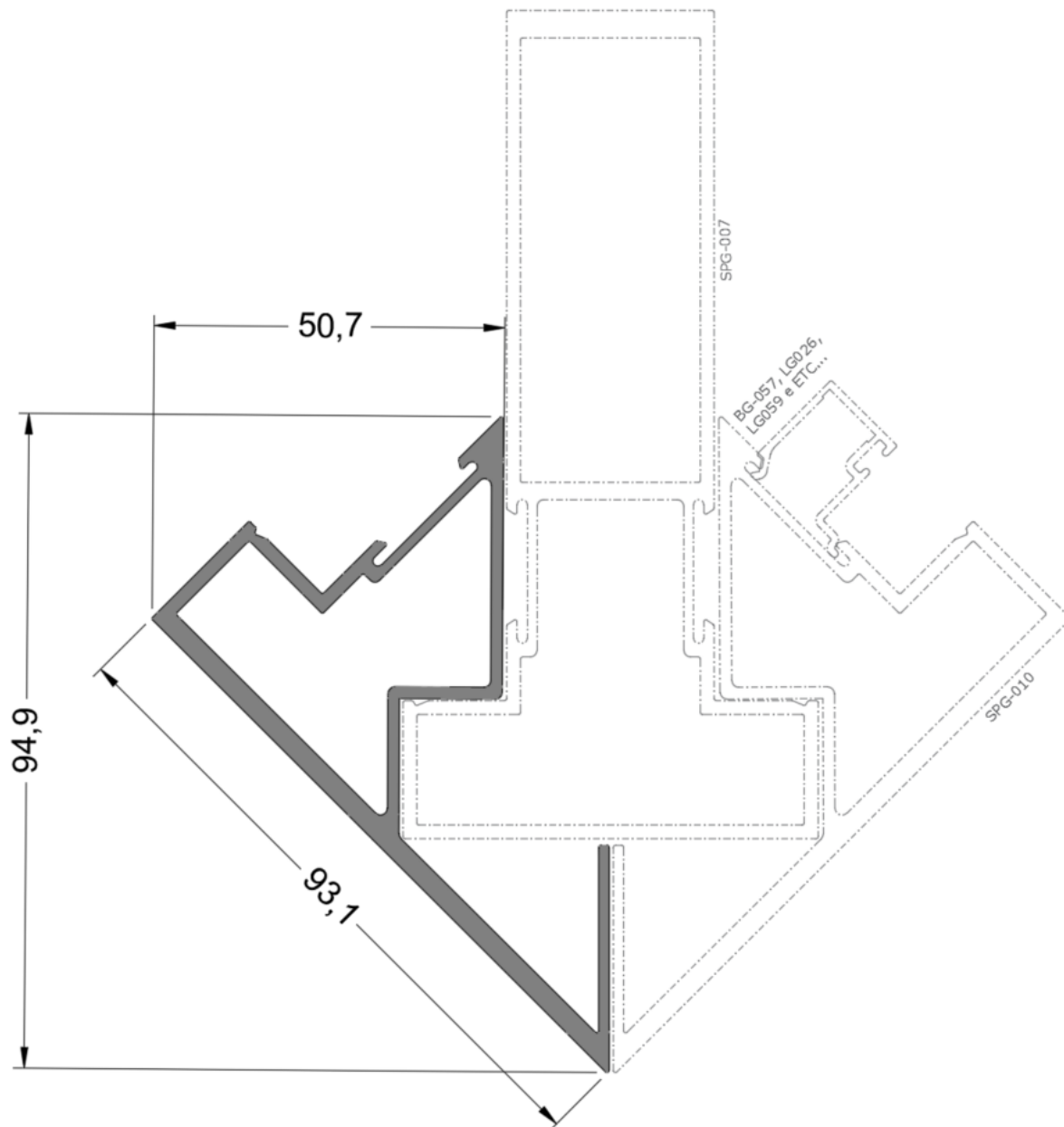
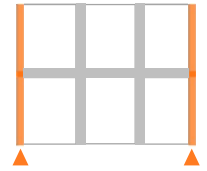

$Jx = 36,4823 \text{ cm}^4$	$Wx = 18,7930 \text{ cm}^4$
$Jy = 7,415 \text{ cm}^4$	$Wy = 5,120 \text{ cm}^4$

## SPG-007

Marco  
0,445 Kg/m

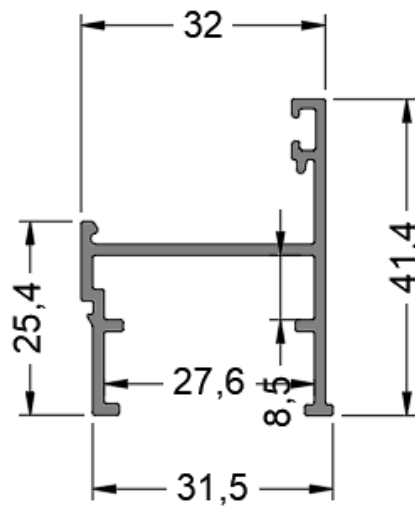
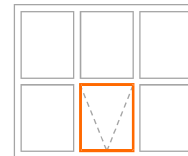

## SPG-003

Marco Glazing  
0,543 Kg/m

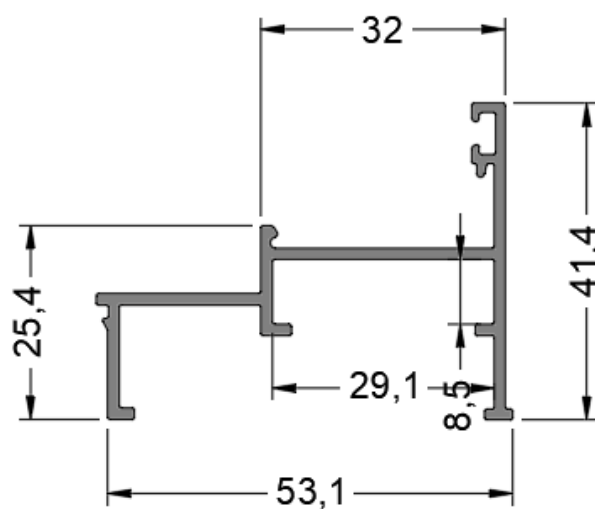
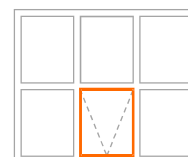

## LG-085

Folha  
0,529 Kg/m

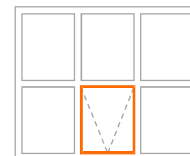
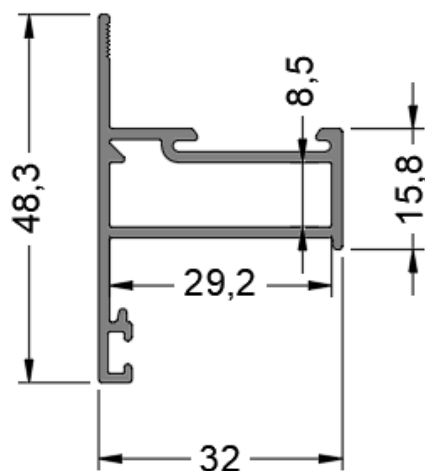

## SPG-004

Folha Glazing  
0,250 Kg/m

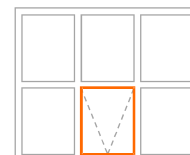
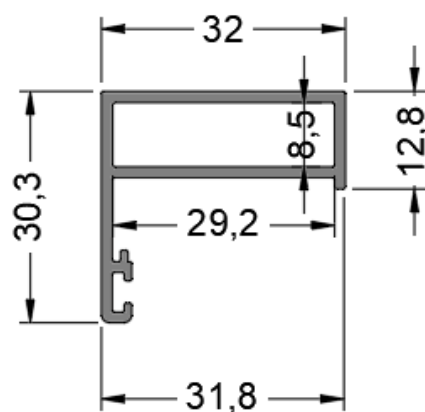

## SPG-008

Fixador De Travessa  
0,228 Kg/m

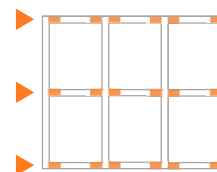
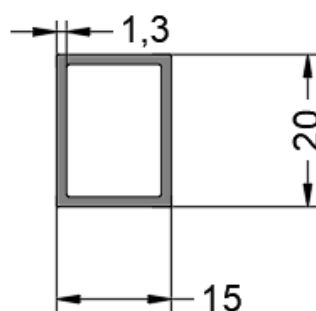

**BG-057**

Baguete  
0,167 Kg/m

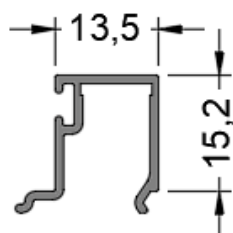

**LG-027**

Baguete  
0,149 Kg/m

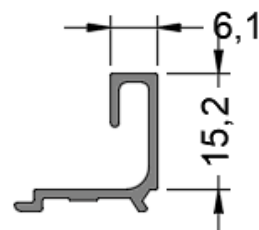

**LG-026**

Baguete  
0,158 Kg/m

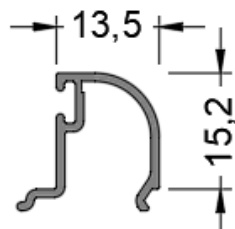
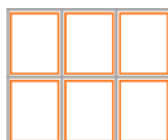

**LG-015**

Baguete  
0,147 Kg/m

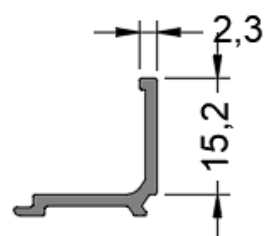
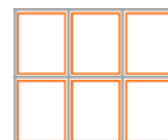

**SPG-6199**

Coluna e Travessa  
3,049 Kg/m

**Perfil sob consulta**

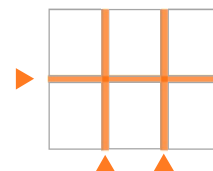

Para região 3 – Até 30 pavimentos ou 90m,  
essa coluna pode ser utilizada com 800mm  
de largura em vãos de até

**5,2 metros de altura**

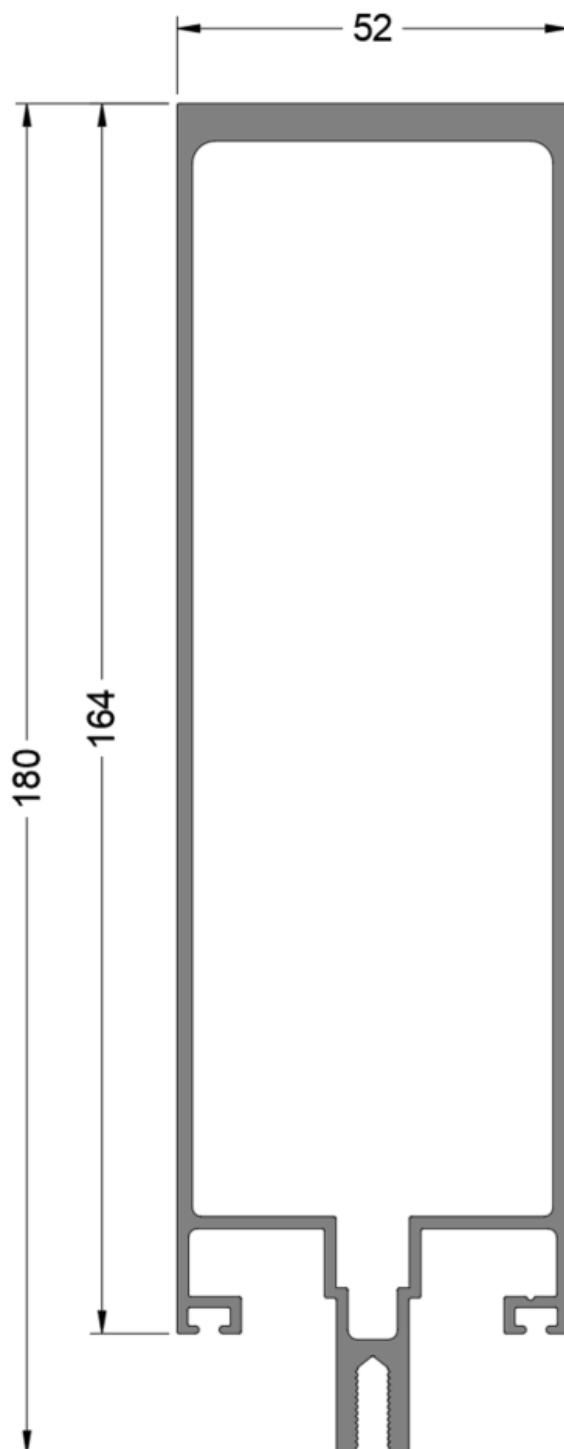

$J_x = 446.0937 \text{ cm}^4$

$W_x = 44.923 \text{ cm}^3$

$J_y = 48.1838 \text{ cm}^4$

$W_y = 18.532 \text{ cm}^3$

**SPG-6200**

Coluna e Travessa  
2.143 Kg/m

**Perfil sob consulta**

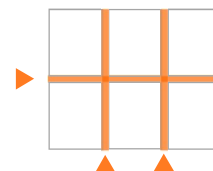

Para região 3 – Até 30 pavimentos ou 90m,  
essa coluna pode ser utilizada com 800 mm  
de largura em vãos de até

**3,7 metros de altura**

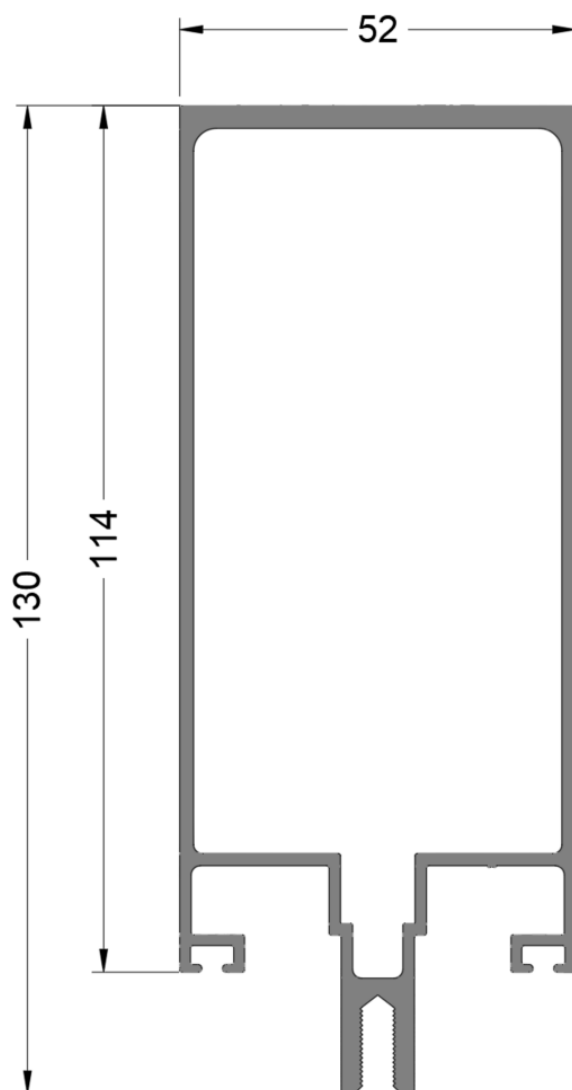

Jx= 158.6235 cm <sup>4</sup>	Wx= 25.379 cm <sup>3</sup>
Jy= 31.6437 cm <sup>4</sup>	Wy= 12.170 cm <sup>3</sup>



**SPG-6201**

Coluna e Travessa  
1,088 Kg/m

**Perfil sob consulta**

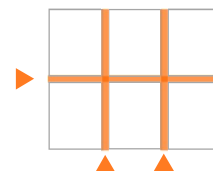

Para região 3 – Até 30 pavimentos ou 90m,  
essa coluna pode ser utilizada com 800 mm  
de largura em vãos de até

**1,8 metros de altura**

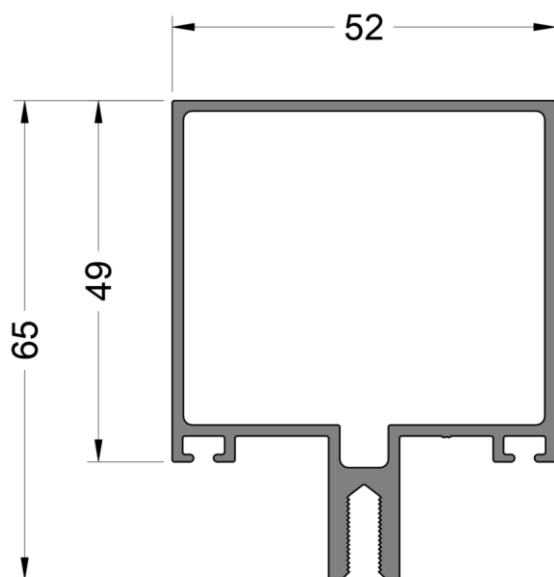

Jx= 18.0223 cm <sup>4</sup>	Wx= 12.9660 cm <sup>3</sup>
Jy= 5.511 cm <sup>4</sup>	Wy= 4.986 cm <sup>3</sup>

**SPG-6204**

Contra tampa  
0,668 Kg/m

Perfil sob consulta

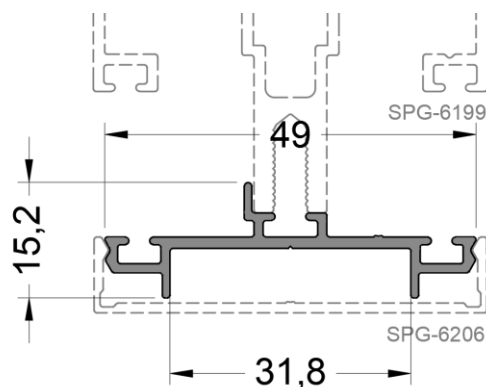
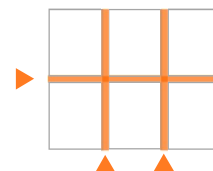

**SPG-6205**

Tampa 14mm  
0,735 Kg/m

Perfil sob consulta

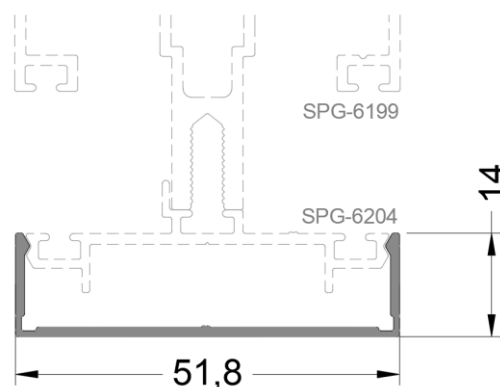

**SPG-6206**

Tampa 10mm  
0,530 Kg/m

Perfil sob consulta

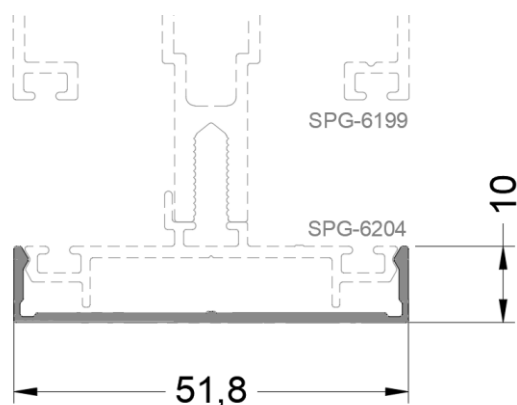

**SPG-6202**

Coluna e Travessa  
1,503 Kg/m

**Perfil sob consulta**

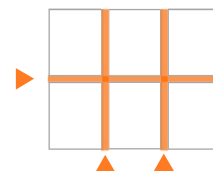

Para região 3 – Até 30 pavimentos ou 90m,  
essa coluna pode ser utilizada com 800 mm  
de largura em vãos de até

**3,4 metros de altura**

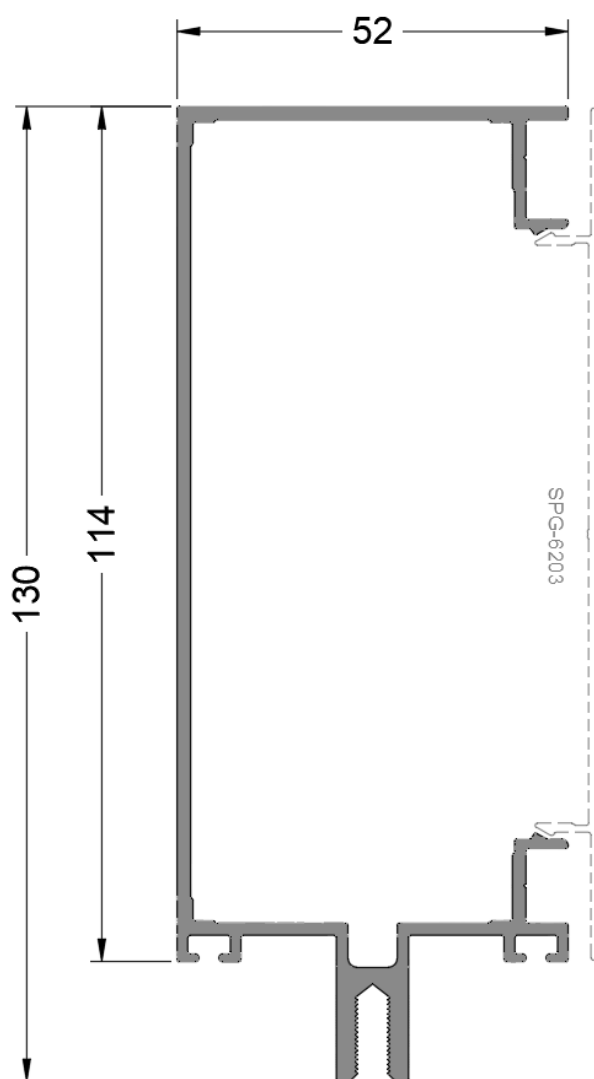



$Jx = 390.972 \text{ cm}^4$	$Wx = 40.223 \text{ cm}^3$
$Jy = 26.073 \text{ cm}^4$	$Wy = 8.691 \text{ cm}^3$

**SPG-6203**

Tampa  
0,477 Kg/m

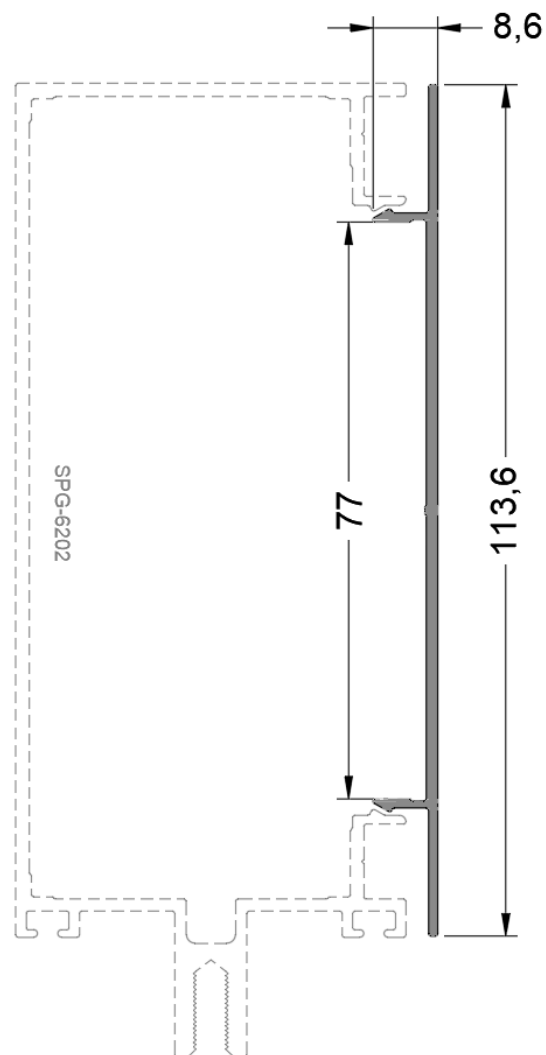
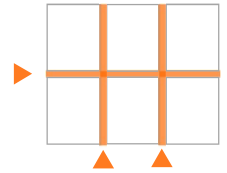
Perfil sob consulta

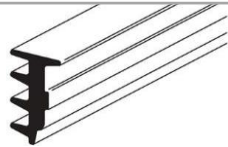

ACESSÓRIO	CÓDIGO	DESCRIÇÃO
	<b>BRAUDMAX 17PD</b>	Braço Projetante (Pág. 8)
	<b>CHUPRP380AINX</b>	Chumbador Expansivo com Prolongador 3/8" x 110 mm – aço Inox
	<b>CHUPFP3802INX</b>	Chumbador Expansivo com prolongador 3/8" x 114 mm – aço inox
	<b>GUA239</b>	Guarnição do Marco EPDM Preto (Pág. 07)
	<b>GUA259</b>	Guarnição do Vidro EPDM Preto (Pág. 07)
	<b>GUA 304</b>	Guarnição Adesiva Esponjosa 14 mm x 6,4 mm – Preta (Pág.07)
	<b>GUA306</b>	Guarnição Adesiva Esponjosa 14 mm x 4,8 mm – Preta (Pág.07)
	<b>FECHO 6735D</b>	Fecho Maxim-ar 6735dD Gold c/ CCTF B7 – Udinese (Pág.09)
	<b>FECHO 735D</b>	Fecho Maxim-ar 735D Gold c/ CCTF B7 – Udinese (Pág.10)
	<b>PAR4213</b>	Parafuso AA Ø 4,2 x 13 mm
	<b>PAR4216</b>	Parafuso AA Ø 4,2 x 13 mm (auto brocante)
	<b>PAR4219</b>	Parafuso AA Ø 4,2 x 19 mm

ACESSÓRIO	CÓDIGO	DESCRIÇÃO
	<b>GUA-2101-PRT</b>	Vidro 10 mm
	<b>GUA-2102-PRT</b>	Vidro 8 mm
	<b>GUA-2103-PRT</b>	Vidro 6 mm
	<b>PRX-PRM-5016-NAT</b>	Parafuso INOX

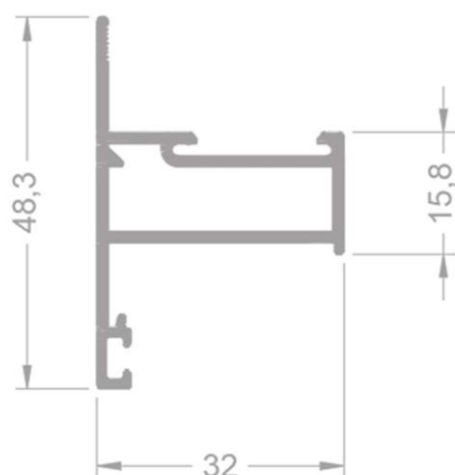

**LG-085**

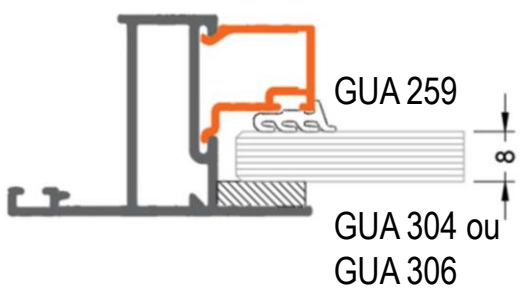
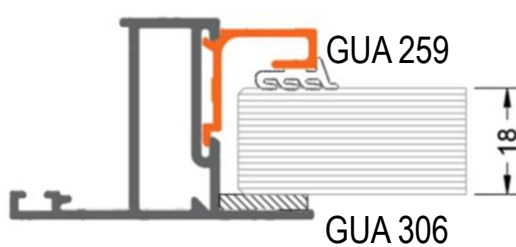
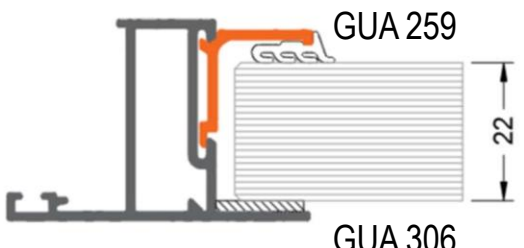
DETALHES		Espessura Vidro (mm)	Guarnição Interna	Guarnição Externa
BG-057 ou LG-056		8	GUA259	GUA304
		10	GUA259	GUA306
LG-027		18	GUA259	GUA306
LG-015		22	GUA259	GUA306

VERSÃO	COR	CÓDIGO UDINESE	CÓDIGO UNIVERSAL	LARGURA MÁX. DA FOLHA (mm)	ALTURA MÁX. DA FOLHA (mm)	CARGA MÁX. (kg)
350	BCO	9103129	BRAUDMAX17PD350BCO	1500	600	22
	PRE	9103132	BRAUDMAX17PD350PTF			
600	BCO	9103134	BRAUDMAX17PD600BCO	1500	1000	35
	PRE	9103137	BRAUDMAX17PD600PTF			
950	BCO	9103139	BRAUDMAX17PD950BCO	1500	1200	42
	PRE	9103142	BRAUDMAX17PD950PTF			
1200	BCO	9103144	BRAUDMAX17PD12000BCO	1500	1500	74
	PRE	9103147	BRAUDMAX17PD12000PTF			

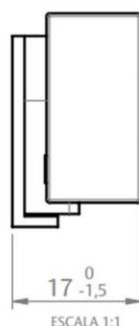
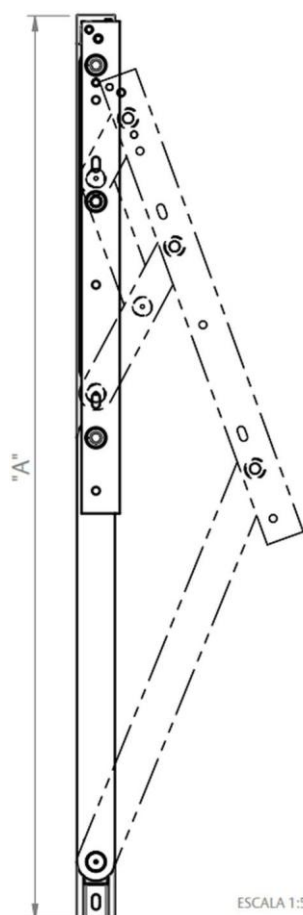

## APLICAÇÃO

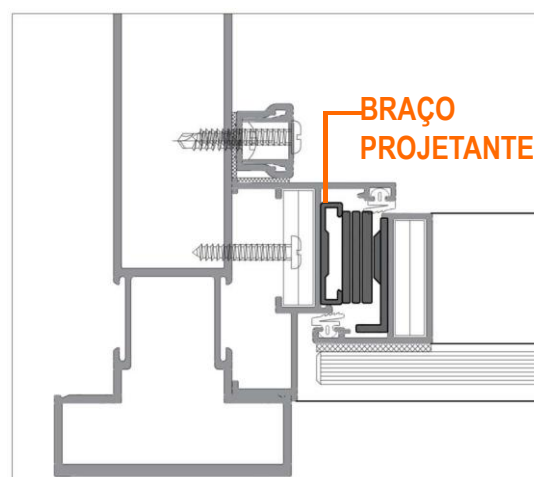

**FECHO MAX-AR 6735D GOLD C/ CCTF B7**

**UDiNESE**  
**ASSA ABLOY**

POSIÇÃO	COR	CÓDIGO	CÓDIGO CATÁLOGO
<b>DIREITO</b>	<b>BCO</b>	<b>9210735</b>	FEC6735DGB7BCO
	<b>PRA</b>	<b>9210736</b>	FEC6735DGB7PRA
	<b>PTF</b>	<b>9210737</b>	FEC6735DGB7PTF
<b>ESQUERDO</b>	<b>BCO</b>	<b>9210738</b>	FEC6735EGB7BCO
	<b>PRA</b>	<b>9210739</b>	FEC6735EGB7PRA
	<b>PTF</b>	<b>9210740</b>	FEC6735EGB7PTF

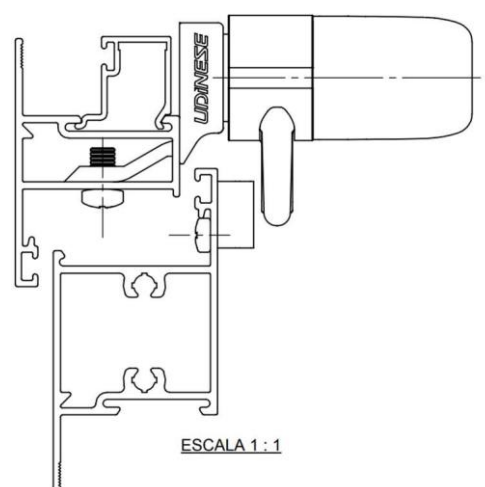
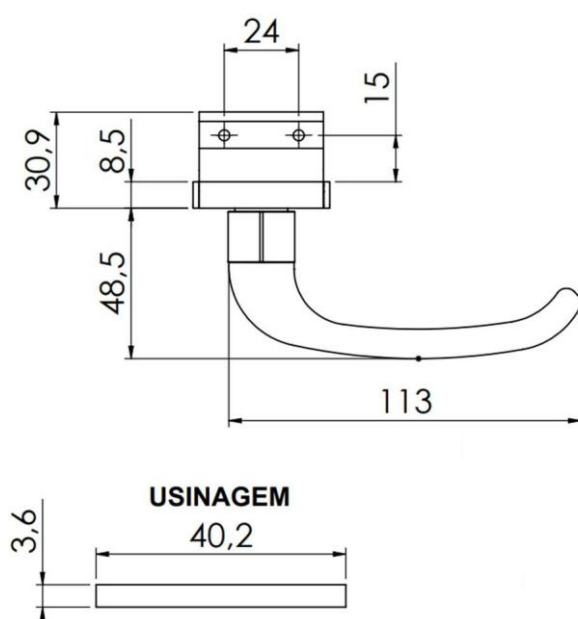

ESCALA 1:1

FECHO MAX-AR 735D GOLD C/ CTF B7



**UDINESE**  
**ASSA ABLOY**

POSIÇÃO	COR	CÓDIGO	CÓDIGO CATÁLOGO
DIREITO	BCO	9210735	FEC735DGOLDBCO
	PRA	9210736	FEC735DGOLDPRA
	PTF	9209334	FEC735DGOLDPTF
ESQUERDO	BCO	9206789	FEC735EGOLDBCO
	PRA	9209657	FEC735EGOLDPRA
	PTF	9209362	FEC735EGOLDPTF

INSTRUÇÃO DE MONTAGEM E USINAGEM

IMAGEM MERAMENTE ILUSTRATIVA

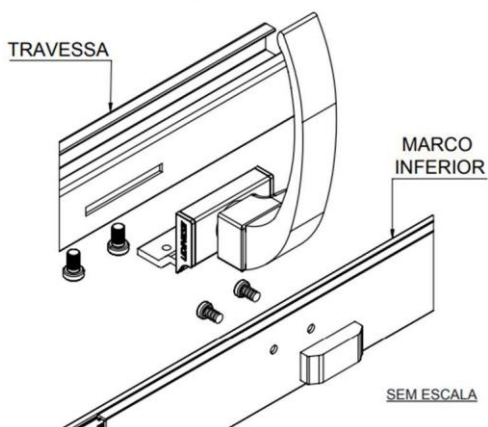

USINAGEM DA TRAVESSA

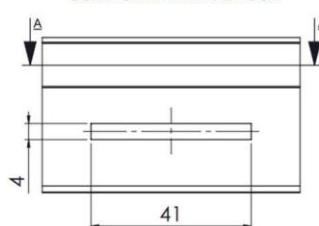

SEÇÃO A-A

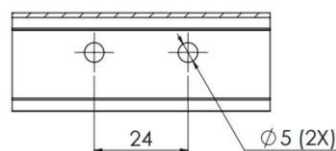

REFERÊNCIA DE USINAGEM

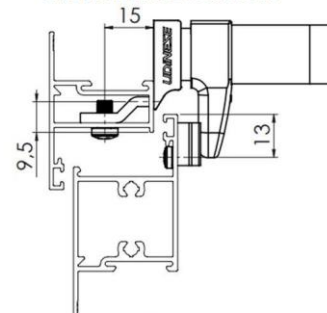

USINAGEM DO MARCO INFERIOR

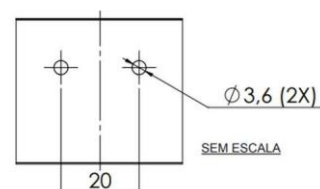

DIMENSÕES

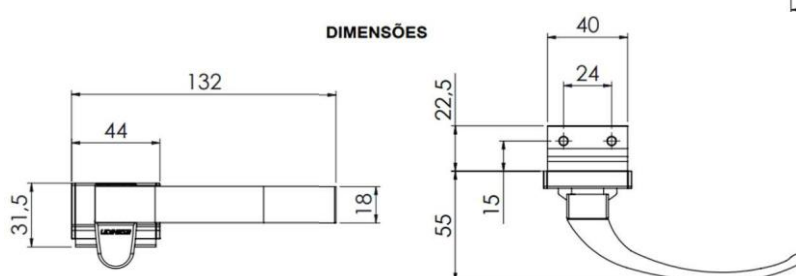

Fachada Simples com "n" módulos

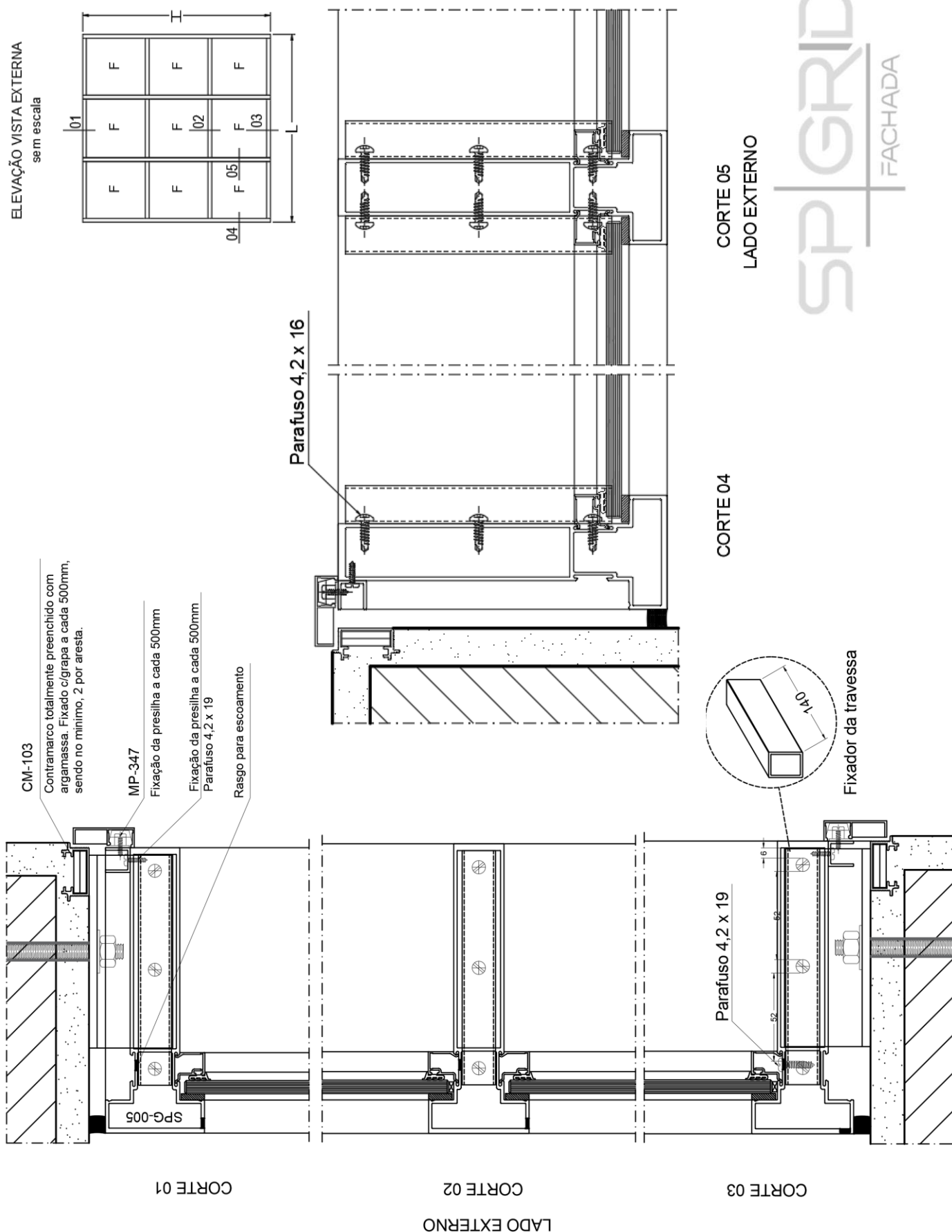

Fachada Simples com Maxim-ar  
Inferior com Baguete

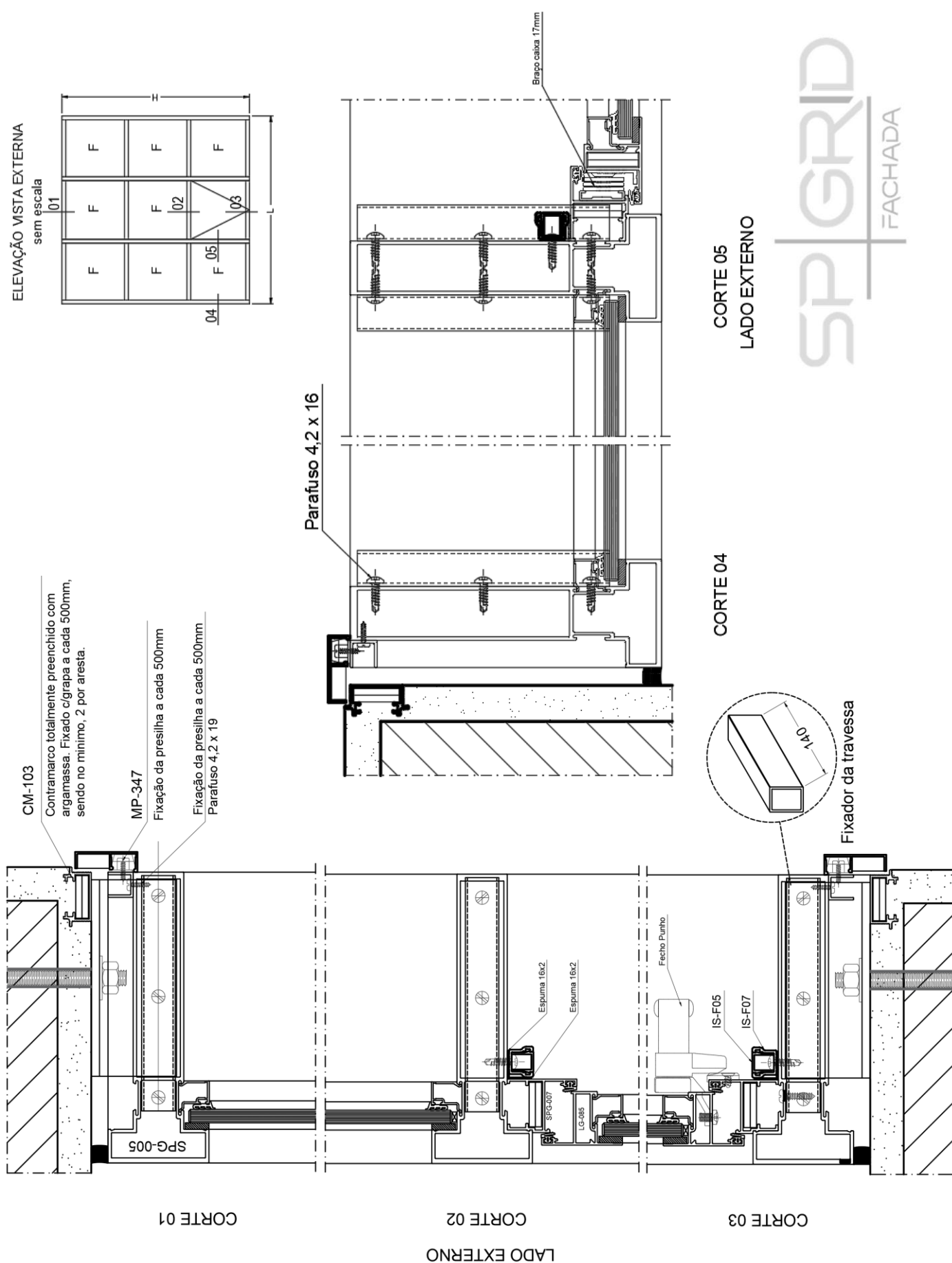



Fachada Simples com Maxim-ar Inferior com  
vidro colado sem Baguete

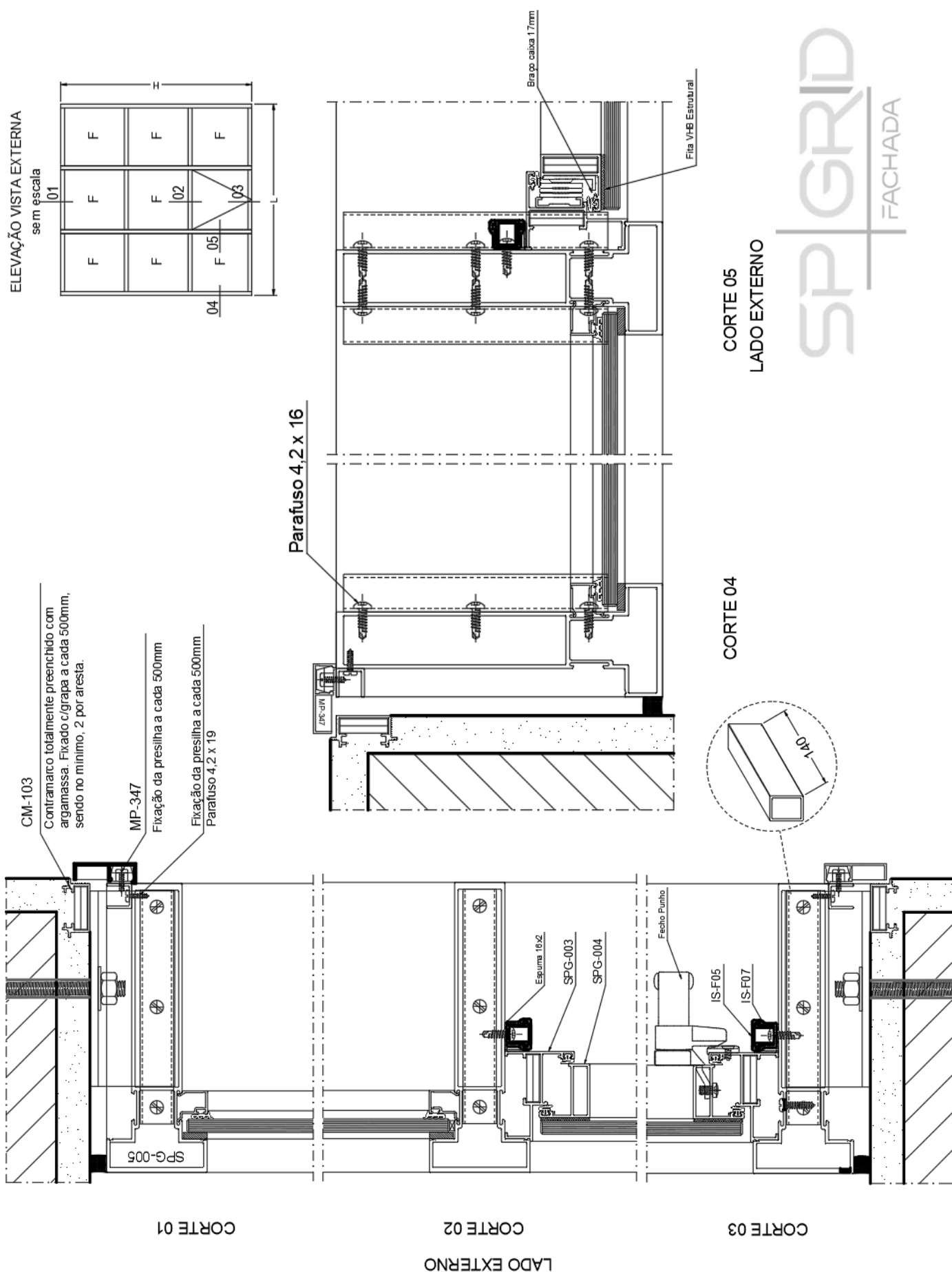

Obrigado,

**aluminorte** Desde 1986  
alumínio e acessórios

Conheça os nossos  
**sistemas no site:**

Acesse o qr code e confira!



Nos acompanhe nas  
**redes sociais** e fique  
por dentro!  
@aluminorte

Ou entre em contato pelo telefone:  
22814822